

AE006L

Environment: outdoor

Nominal lifetime: >50'000h

#### ELECTRICAL DATA

Wattage: 10W  
Voltage IN: 220 ~ 240VAC  
Voltage OUT: 2-28,5V  
Management: On/Off  
Output current: 350mA

#### WEIGHT & DIMENSIONS

Dimensions: Ø 10,5cm Height 7,4cm  
Ambient temp. range: (ta) -20...+50 °C  
Materials: Body: Plastic structure  
Weight: 600gr



Driver 10W 350mA 2-28,5V

350mA 2-28,5V  
Constant current power supply

Power 10W  
Ø 10,5cm Height 7,4cm

#### CERTIFICATIONS

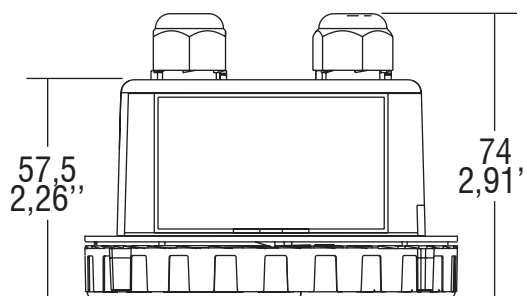
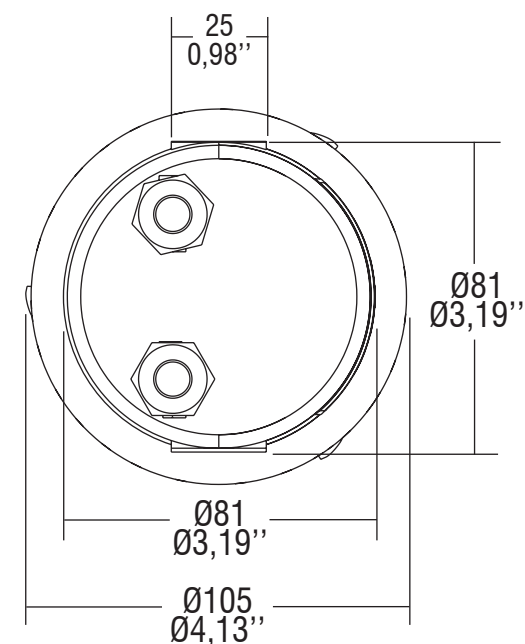
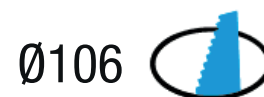

Dimensions